

4

3

2

1

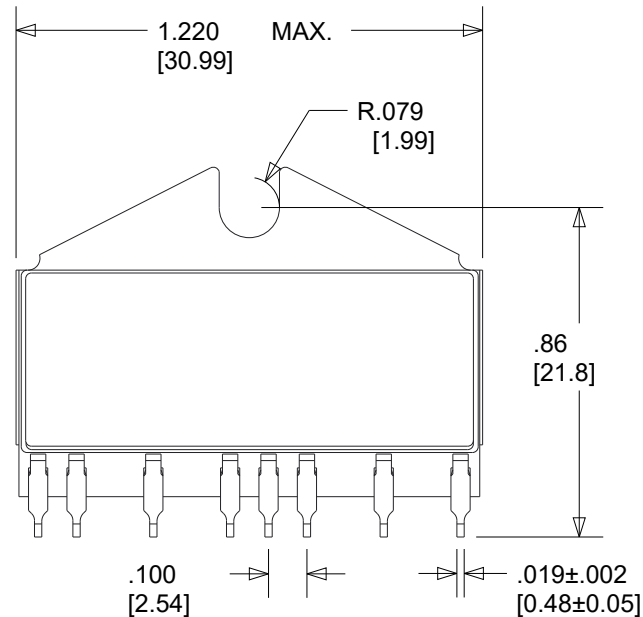
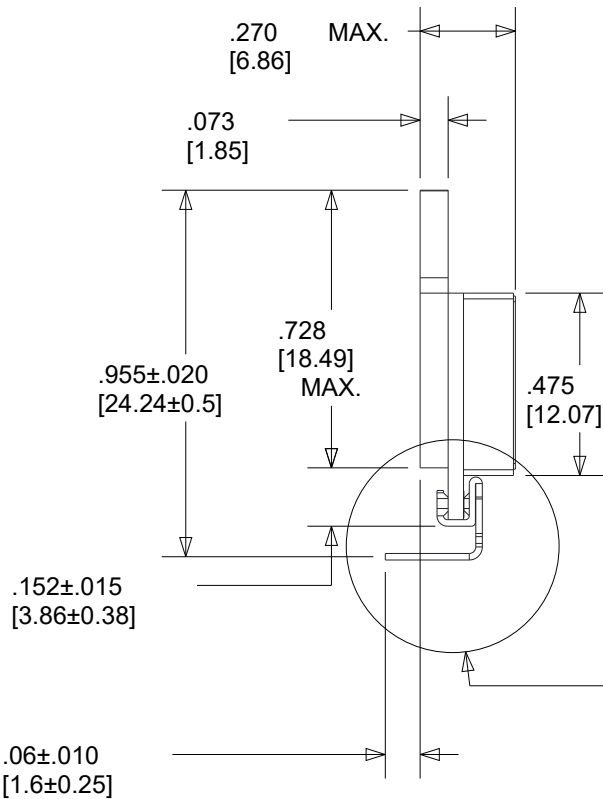
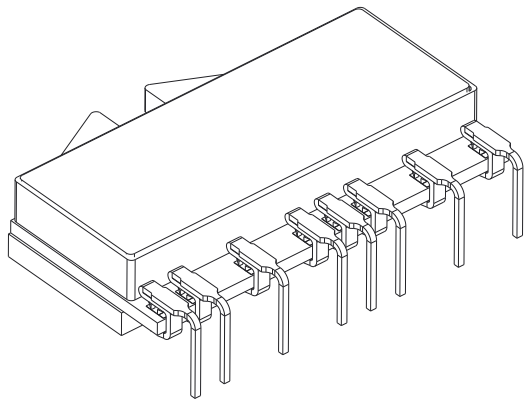

SEE DETAIL A

DETAIL A  
SCALE 4.000

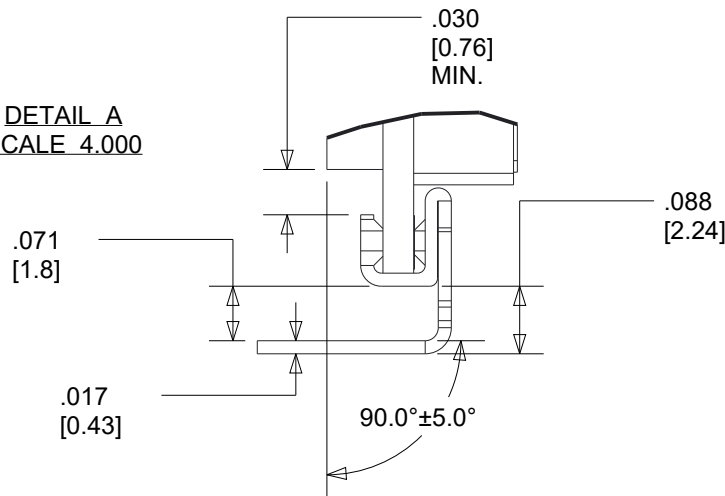

**NOTES:**

1. Dimensions are in inches & [mm].
2. Triangle on lid denotes Pin 1.
3. Pins: Alloy 510 phosphor bronze plated with matte tin (150-300 microinches) over nickel (50 microinches max.) underplate.
4. Package: Vectra liquid crystal polymer (black),beryllium oxide substrate, and nickel plated C.R.S header.
5. Epoxy-sealed and ultrasonically welded non-hermetic package.
6. Package weight: .37 oz [11.4 g]

TOLERANCES - UNLESS OTHERWISE SPECIFIED  
 .XX = +/- .05" [.254]  
 .XXX = +/- .005" [.127]  
 ANG. = +/- 2 DEGREES



TITLE: 8-PIN SIP, 90° REV. FORMED LEADS, .063" LENGTH  
 SUBJECT: PACKAGE OUTLINE  
 ENGINEER: EAS  
 DRAWN BY: EAS  
 DCA: 18382  
 SH. 1 OF 1

MODEL: RC  
 FILENAME: RC  
 REV: A  
 DATE: 21SEP18

4

3

2

1