

NOTES:

1. Dimensions are in inches & [mm].
2. Triangle on lid denotes Pin 1.
3. Pins: Alloy 510 phosphor bronze plated with matte tin (150-300u") over nickel (500u" max.) underplate.
4. Epoxy-sealed & ultrasonically welded non-hermetic package.
5. Creepage distance between I/O pin pads: 0.050 inches.
6. The exposed substrate contains BeO. Do not crush, machine or subject to temperatures in excess of 850° C to avoid generating toxic fumes.

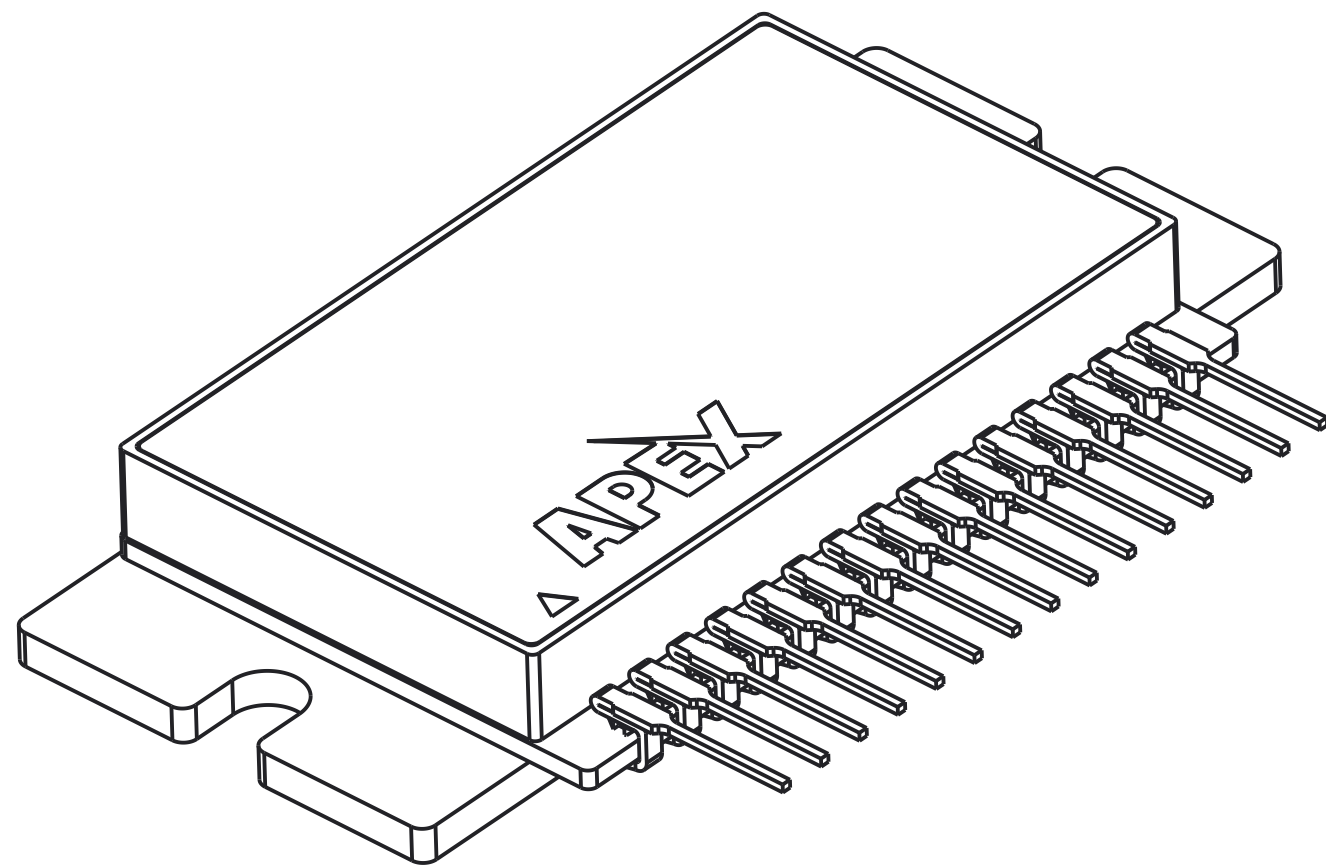

SCALE 3.000

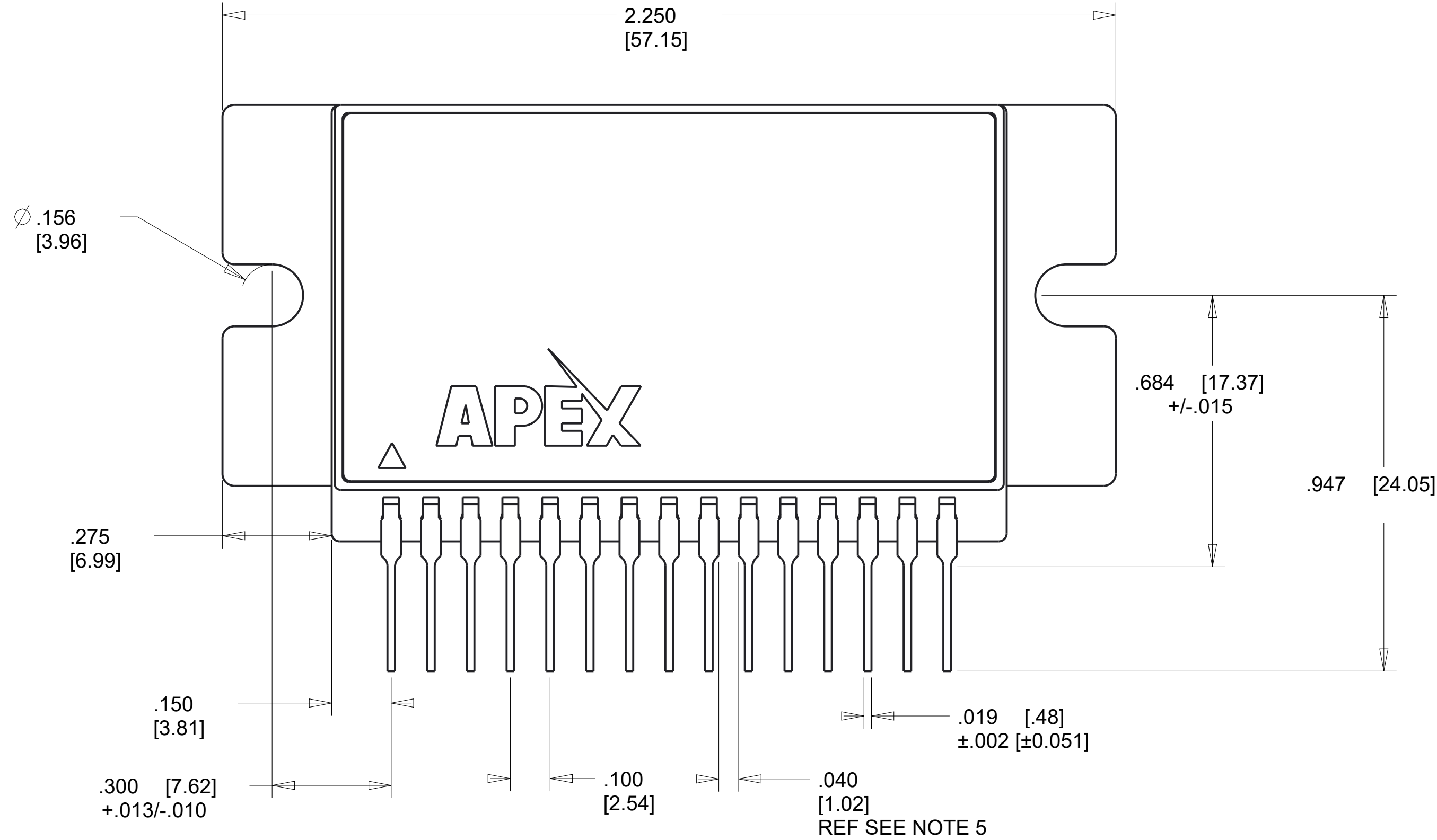
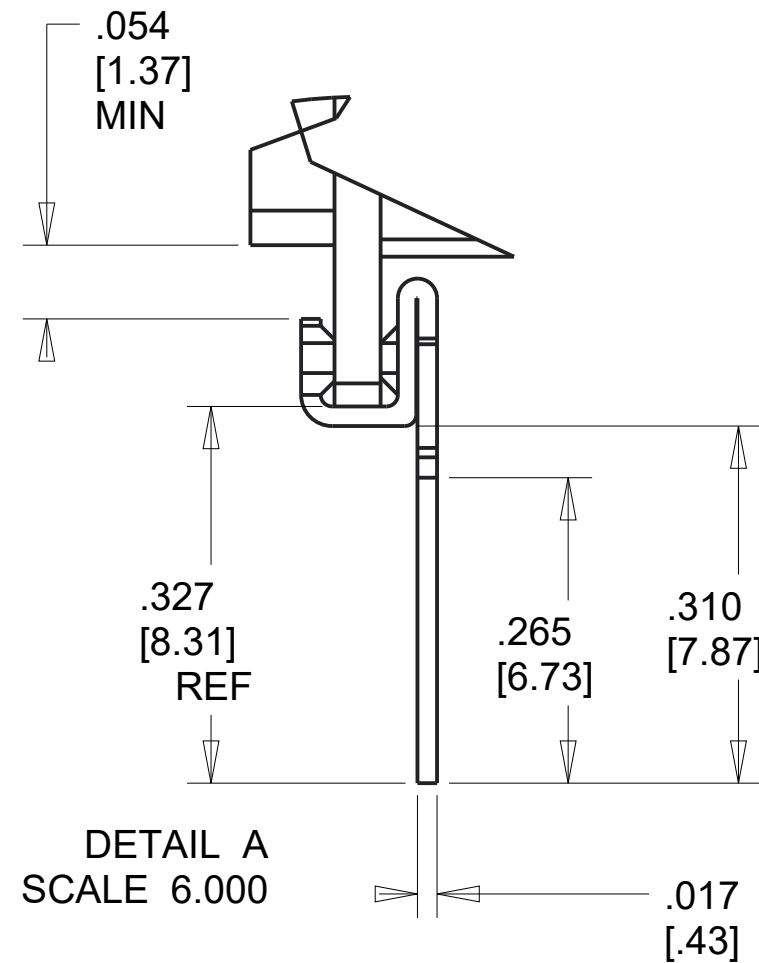
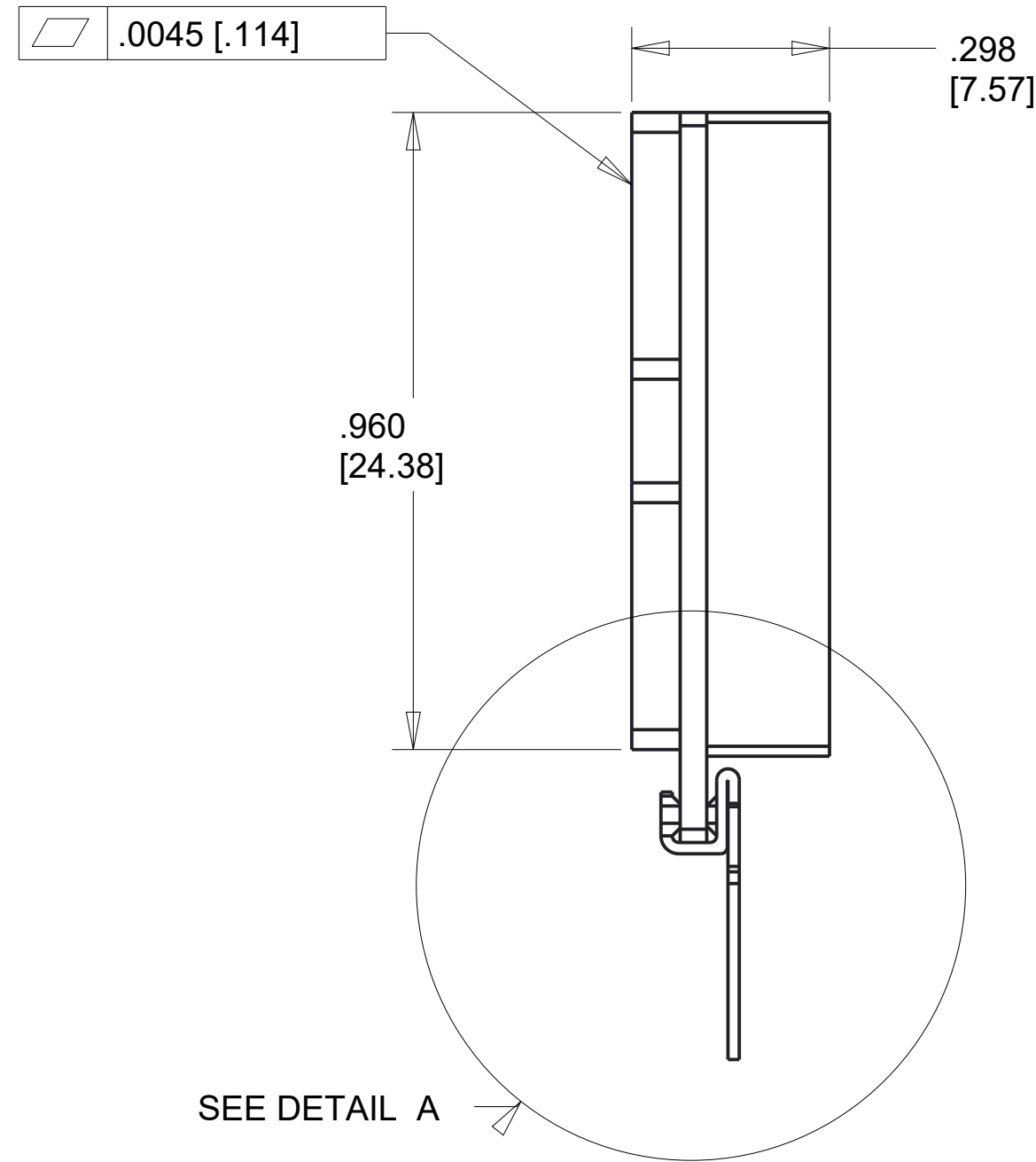

TOLERANCES - UNLESS OTHERWISE SPECIFIED

.XX ± .01 [.254]  
.XXX ± .005 [.127]  
ANG. ±5°

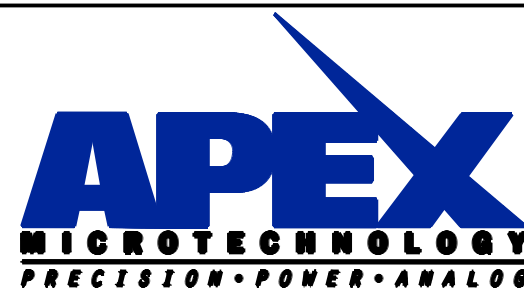

TITLE: 15-PIN POWER SIP

SUBJECT: PACKAGE OUTLINE

ENGINEER: MJM    DRAWN BY: MJM    DCA: 20079    SH. 1    OF 1

MODEL: LL

FILENAME: LL    REV: B    DATE: 4/20/20