

4

3

2

1

D

D

C

C

B

B

A

A

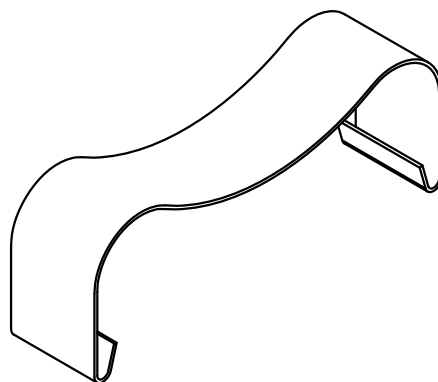
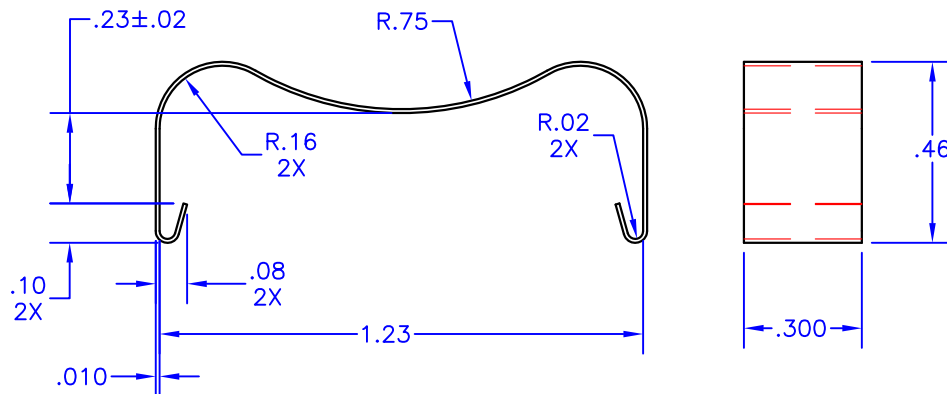
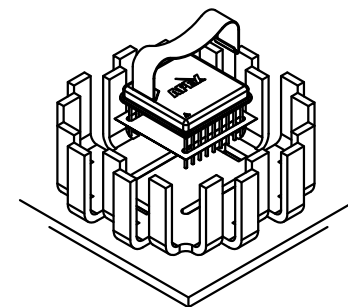

NOTES:

1. Unless otherwise noted, dimensions are in inches.
2. Break all sharp edges, de-burr and remove loose chips.
3. Material: .010 thick 302 stainless, full hard
4. Finish: None
5. Used with HS21 heatsink.
6. Approximate weight: .03 oz. [.85 g]

TOLERANCES - UNLESS OTHERWISE SPECIFIED
.XX = ±.01 [.254]
.XXX = ±.005 [.127]
ANG. = ±5°



TITLE: DIP CLAMP	
SUBJECT: MECHANICAL DRAWING	
ENGINEER: D-M	DRAWN BY: R.MOR
DCAL: 13239	SH. OF 1 1

MODEL: CLAMP02	REV: E	DATE: 03JUN13
----------------	--------	---------------

4

3

2

1